

LEGEND

DISTRICT "A" RESIDENTIAL (REFER TO BUILDING ZONE ORDINANCE FOR LOT AREA REQUIREMENTS)

DISTRICT "A-1" RESIDENTIAL (REFER TO BUILDING ZONE ORDINANCE FOR LOT AREA REQUIREMENTS)

DISTRICT "B" RESIDENTIAL (REFER TO BUILDING ZONE ORDINANCE FOR LOT AREA REQUIREMENTS)

DISTRICT "B-1" RESIDENTIAL (REFER TO BUILDING ZONE ORDINANCE FOR LOT AREA REQUIREMENTS)



BOUNDARY LINES OF VILLAGE ARE DENOTED
THUS - - - - -

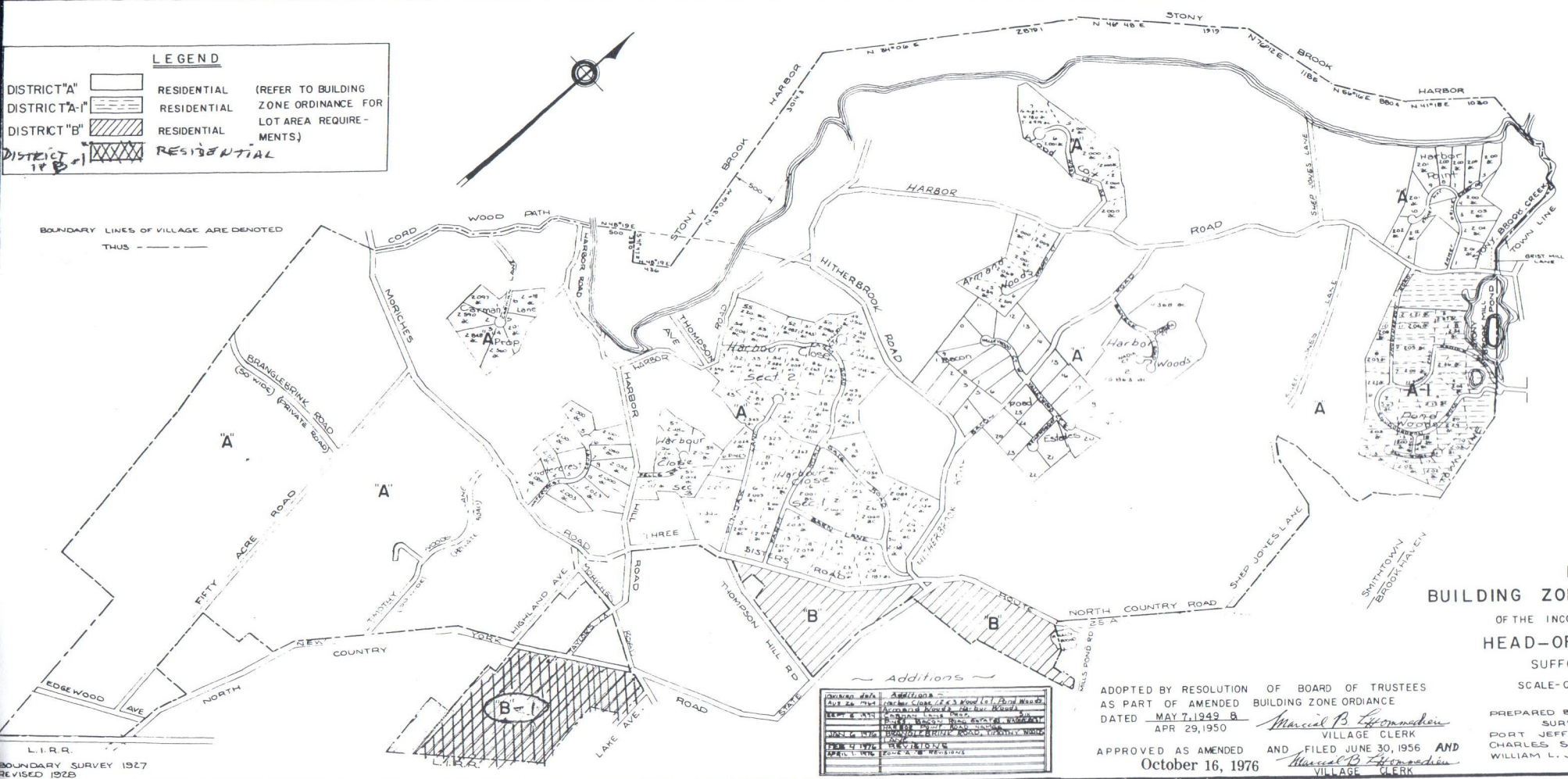

L.I.R.R.
BOUNDARY SURVEY 1927
REVISED 1928

~ Additions ~

DATE	DESCRIPTION
APR 29, 1950	ADDED TO DISTRICT B
MAY 7, 1949	ADDED TO DISTRICT B
JUNE 30, 1956	ADDED TO DISTRICT B
OCTOBER 16, 1976	ADDED TO DISTRICT B

**REVISED
BUILDING ZONE ORDINANCE**
OF THE INCORPORATED
**HEAD-OF-THE-
SUFFOLK CO.**

ADOPTED BY RESOLUTION OF BOARD OF TRUSTEES
AS PART OF AMENDED BUILDING ZONE ORDINANCE
DATED MAY 7, 1949 AND APR 29, 1950
Marcell B. Thompson
VILLAGE CLERK
APPROVED AS AMENDED AND FILED JUNE 30, 1956 AND
OCTOBER 16, 1976
Marcell B. Thompson
VILLAGE CLERK

SCALE-ONE INCH = 6
PREPARED BY HAWKINS,
SURVEYING &
PORT JEFFERSON, N.S.
CHARLES S. WEBB JR. &
WILLIAM L. JAEGER II. D.

and adopted on: **FEB. 9, 1991**